

Super
NOVA™
WS-400
evo



GB • WS_400 evo Инструкция

ANEST IWATA Europe S.r.l.
Corso Vigevano, 46 - 10155, Torino (Italy)
Direct Tel. +39 011 - 22 74 402
Fax +39 011 - 22 74 000
info@anest-iwataeu.com
www.anest-iwataeu.com

ANEST IWATA Italia S.r.l.
Corso Vigevano, 46 - 10155, Torino (Italy)
Tel. diretto +39 011 - 24 80 868 - Fax: +39 011 - 85 19 44
info@anest-iwata.it www.anest-iwata.it

ANEST IWATA Iberica
Calle de Les Teixidores, 3-5
08918 - Badalona (Barcelona)
Tel.: +34 93 32 05 993 - Fax.: +34 93 32 05 965
info@anest-iwata.es www.anest-iwata.es

ANEST IWATA Deutschland
Mommensenstrasse 5
04329 Leipzig
Telefon: +49 (0)341 241 44 30 - Fax: +49 (0)341 252 55 95
info@anest-iwata.de www.anest-iwata.de

European Sales Branches:

ANEST IWATA Scandinavia
Ögärdesvägen 6C, 433 30 PARTILLE - Sweden
Tel. +46 (0)31 - 340 28 60 - Fax +46 (0)31 - 340 28 69
info@anest-iwata.se www.anest-iwata.se

ANEST IWATA France
25 rue de Madrid - 38070 St Quentin Fallavier - France
Tél. +33 (0)4 - 74 94 59 69 - Fax +33 (0)4 - 74 94 34 39
info@anest-iwata.fr www.anest-iwata.fr

ANEST IWATA U.K.
Unit 10 Little End Road - Eaton Socon
St. Neots - CAMBRIDGESHIRE
PE19 8JH
Tel.: +44 (0) 1480 40 54 19 Fax: +44 (0) 1480 21 76 10
enquiries@anest-iwata.co.uk www.anest-iwata.co.uk

⚠ Before use, adjustment or maintenance, it is important to read this instruction manual very carefully. This manual must be stored in a safe place for any future reference.

This ANEST IWATA spray guns kit complies to ATEX regulations 94/9/EC, protection level: **CE Ex II 2G X** II 2 G X Suitable for using Zones 1 and 2.
X marking: Any static electricity discharge from the spray gun is to be diverted to the ground via the conductive air hose as stipulated.

⚠ ALWAYS observe WARNINGS and CAUTIONS in this instruction manual.

Symbol	WARNING	Hazard level	Consequence
	WARNING	Potentially hazardous situation	Death or serious injury
	CAUTION	Potentially hazardous situation	Minor to moderate injury
	IMPORTANT	Potentially hazardous situation	Property damage

1. TECHNICAL SPECIFICATIONS

Max. working air pressure:	7.0 bar (100 PSI)	Air connection:	G 1/4" M
Noise Level (LAeqT)*:	75.8 dB (A)	Fluid connection:	G 1/4" F
Max. Temperature range:	5 ~ 40 °C	Weight g (lbs)**:	475 (1.05)

* Measuring point: 1m backwards from gun, 1.6m height. ** Weight without cup.

Model	Nozzle size Ø	Air cap set Mark	Fluid output ml/min	Air consumption NI/min	Pattern Width at 130 mm	Pattern Width at 200 mm
Air pressure at gun inlet 2 bar						
WS400-1201*	1.2		120	370	250	350
WS400-1301B*	Base 1.3		140		260	365
WS400-1301C*	Clear 1.3		170		260	365
WS400-1401B*	Base 1.4		170		260	365
WS400-1401C*	Clear 1.4		190		260	370
WS400-1301BH*	1.3 HD (1.3.2)	WS-400-01	220		265	365
WS400-1301CH*	(1.3.2)		220		265	365
WS400-1401BH*	1.4 HD (1.4.2)		240		270	370
WS400-1401CH*	(1.4.2)		240		270	370
WS400-1501BH*	1.5 HD (1.5.2)		260		275	370
WS400-1501CH*	(1.5.2)		260		275	370
WS400-1301OBS*	Base 1.3		160		260	365

2. SAFETY WARNING
FIRE AND EXPLOSION



- Never use the following HALOGENATED HYDROCARBON SOLVENTS:** which can cause cracks or dissolution of gun body (aluminium) due to chemical reaction. UNSUITABLE SOLVENTS: methyl chloride, dichloro-methane, 1,2-dichloroethane, carbon tetrachloride, trichloroethylene, 1,1,1-trichloroethane
- Sparks and open flames are strictly prohibited.** Paints can be highly flammable and can cause fire. Do not expose to open flames, electrical goods, cigarettes etc.
- Securely ground spray gun using conductive air hose.** (Less than 1MΩ) Always ensure that the spray gun is earthed correctly.

PROTECTION OF HUMAN BODY



- Use in a well-ventilated site, using a spray booth.**
Poor ventilation can cause organic solvent poisoning and fire.
- Always wear protective gear (safety glasses, mask, gloves) to avoid inflammation of eyes and skin.**
In case of any physical discomfort, immediately seek medical advice.
- Wear earplugs if necessary.**
Noise level can exceed 80 dB(A), depending on operating conditions and painting site.
- Pulling the trigger many times during operation, may cause carpal tunnel syndrome.** Always rest, in case of tiredness.

IMPROPER USE



- Never point gun towards people or animals.**
- Never exceed maximum working pressure or maximum operating Temperature**
- Always release air and fluid pressure before cleaning, disassembling or servicing.** Otherwise, remaining pressure can cause bodily injury due to improper operation or scattering of cleaning liquid.
- Tip of fluid needle set has a sharp point.**
Do not touch the tip during maintenance to avoid accidents.
- Never use this gun to spray foods or chemicals.**
Otherwise, foreign substance, could cause corrosion of fluid passages which could adversely affect health.
- Never alter this spray gun,** to avoid insufficient performance and damage.
- If something goes wrong, immediately stop operation and find the cause. Do not use again, until you have solved the problem.**
- Do not enter working areas, where robots, reciprocators, etc. are used, until they have been turned off.** Otherwise, they could cause injury.

3. HOW TO USE

CAUTION



- Use clean air filtered through air dryer and air filter.
 - When using this gun for the first time after purchase, adjust fluid needle packing set (3), spray cleaner to clean fluid passages and remove rust preventive oil.**
 - Firmly fix hose or container to spray gun, to avoid disconnection of hose or container, that can cause bodily injury.**
- Firmly connect an air hose to air nipple 1/4"(4-2).
 - Firmly connect a suitable cup to fluid nipple (4-1).
 - Flush fluid passages with a compatible solvent.
 - Pour paint into container, test spray, adjust fluid output and pattern width.

4. HOW TO OPERATE

- Suggested atomizing air pressure is 1.5 to 2.5 bar (21 to 36 PSI).
- Recommended paint viscosity differs according to paint property and painting conditions. 14 to 25 sec. / Ford cup#4 is recommended.
- Set the spray distance from the gun to the work piece, as near as possible within the range of 130-200 mm.
- The gun should be held so that it is perpendicular to the surface of the workpiece at all times. Then, the gun should move in a straight and horizontal line. Arcing the gun causes uneven painting.

5. MAINTENANCE AND INSPECTION



Before carrying out maintenance and inspection ALWAYS observe WARNING indications.

CAUTION

- Never use spare parts that are not Anest Iwata originals.**
- Never damage fluid nozzle tip, fluid needle or air cap holes.**
- Never immerse the spray gun completely in liquids such as thinner.**

5.1 MANUAL CLEANING PROCEDURE



The fluid passages of the gun, must be cleaned thoroughly after each use, especially after use with bi-component paints. Incomplete cleaning can cause defective pattern shape.

European Directives:
1994/9/CE - 1999/92/CE



DECLARATION OF CONFORMITY

We ANEST IWATA Europe s.r.l. - Corso Vigevano, 46 - 10155 Torino - Italy declare, under our sole responsibility, that the product:

WS-400EVO SPRAY GUN

to which this declaration relates, is in conformity with European ATEX Directive 94/9/CE for use in zone 1 and zone 2 and Machinery Directive 2006/42/CE.

According with the following international requirements:
EN 1127-1:2008, EN 13463-1:2009, EN ISO 121000:2010 and EN 1953:2010.

Name and position of issuer: Mr. Marco G. VICENTINI, Managing Director

Signature:

Date: 01.03.2011

6. TROUBLESHOOTING

GUN DOES NOT SPRAY



- Fluid adj. knob (13) closed. Check and adjust.
- Tip hole of nozzle obstructed. Check and clean.
- Paint filter obstructed. Check and clean.
- Non drip obstructed. Check and clean.

INTERMITTENT SPRAY PATTERN



- Air escapes from fluid nozzle (2-1). Check, clean & replace if necessary.
- Air escapes from fluid needle packing (3). Tighten.
- Air escapes from cup joint or fluid hose joint. Tighten.
- Dirt inside air cap (1). Clean.

DEFECTIVE SPRAY PATTERN

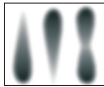

- Dirty nozzle (2-1) or air cap (1). Clean carefully.
- Nozzle (2-1) or air cap (1) has been damaged. Replace if damaged.
- Fluid nozzle (2-1) is loose. Tighten.
- Paint viscosity too high or too low. Dilute paint or increase viscosity.
- Fluid output too high or too low. Adjust fluid adj. knob (13) to reduce or increase.

LEAKING



- Fluid nozzle (2-1), needle set (2-2) or gun body (4), dirty, damaged or worn on seat. Clean or replace if necessary.
- Dirt inside air cap (1). Clean.
- Loose fluid adj. knob (13). Adjust.
- Fluid needle spring (11) is worn. Replace.
- Loose fluid nozzle (2-1). Tighten.
- Needle packing set (3) loose, too tight, dirty or worn. Adjust, clean or replace.

AIR ESCAPES FROM AIR CAP

- Air valve (8), air valve seat (7) or air valve spring (9) dirty or damaged. Clean or replace if necessary.
- Air valve seat set o ring (7-1) damaged or worn. Replace.

7. SPARE PARTS LIST

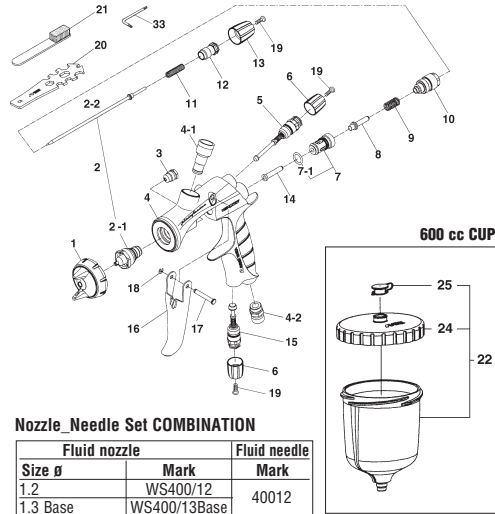

Nozzle_Needle Set COMBINATION

Fluid nozzle		Fluid needle
Size Ø	Mark	Mark
1.2	WS400/12	
1.3 Base	WS400/13Base	40012
1.3 Clear	WS400/13Clear	
1.4 Base	WS400/14Base	
1.4 Clear	WS400/14Clear	
1.3 HD (1.3.2)	WS400/13 HD	20015
1.4 HD (1.4.2)	WS400/14 HD	
1.5 HD (1.5.2)	WS400/15 HD	
1.3 OBS	WS400/13 OBS	

DESCRIPTION	REF.
Air cap	Ref. 1
Fluid Nozzle + Fluid needle set	Ref. 2 ●
Fluid Nozzle	Ref. 2-1 ●
Fluid needle	Ref. 2-2 ●
Needle packing set	Ref. 3 ●
Body set	Ref. 4
Fluid nipple *	Ref. 4-1
Air nipple	Ref. 4-2
Pattern adjustment set	Ref. 5
Adjustment knob	Ref. 6
Air valve seat *	Ref. 7
O'ring	Ref. 7-1
Air valve	Ref. 8 ●
Air valve spring	Ref. 9
Fluid adjustment guide	Ref. 10
Needle spring	Ref. 11
Fluid adjustment screw	Ref. 12
Fluid adjustment knob	Ref. 13
Air valve shaft	Ref. 14
Air adjustment set	Ref. 15 ●
Trigger	Ref. 16
Trigger stud	Ref. 17
E stopper	Ref. 18
Countersunk socket screw (Torx T10)	Ref. 19
Spanner	Ref. 20
Brush	Ref. 21
Cup 600 cc	Ref. 22
Lid	Ref. 24
Knob	Ref. 25
Allen wrench	Ref. 33
Filter (optional)	

● Marked parts are wearable parts.

NOTE: When ordering parts, specify gun model, part name with ref. No. and marked No. of air cap set, fluid nozzle and fluid needle.

- Never soak air cap set (1) in solvent for an extended period, even when cleaning.

- Never use metal brush to clean the gun.

1. Drain remaining paint from spray gun and cup, into a suitable container.
2. Pour cleaner into cup.
3. Unscrew air cap (1) by 2 turns, to allow atomizing air to back flush, fluid passages of the gun.
4. Pull trigger (16) and make sure, that atomizing air enters cup.
5. Leave cleaner for a few seconds, then empty it into suitable waste container.
6. Repeat procedure above, until spray gun is clean.
7. Remove air cap (1) and cup from gun, then clean each section with brush soaked with cleaner and wipe out with waste cloth.
8. DRY ALL PARTS completely and apply spray gun lubricant to each thread.

5.2 AUTOMATIC CLEANING PROCEDURE

- When using automatic spray gun washer, follow the instruction manual provided with it. Before cleaning, make sure air is released from air passages.
- Only use suitable cleaner designed for your spray gun washer.
- Make sure that the equipment is dried immediately after cleaning.
- Do not leave spray guns inside spray gun washer, after cleaning. Cleaner vapour can damage packings and cause corrosion inside gun body.
- Do not leave spray guns soaking in cleaner.
- Securely ground washer equipment.
- Use of cleaner with waterborne coatings, can increase PH level, especially after several cleanings. Please, replace the cleaner regularly in order to always ensure the best spray gun performance.
- Make sure that the PH level of cleaner does not exceed the limit. PH level: 6.0-8.0 (but only during cleaning).

5.3 DISASSEMBLY PROCEDURE

- Before disassembly, fully clean fluid passages.



a. Disassemble fluid nozzle (2-1), while keeping fluid needle (2-2) pulled (triggering) in order to protect its seat section.

b. Disassemble fluid needle set (2-2), (only when strictly necessary)

- c. Remove fluid adj. knob (13), fluid adj. set (12) and needle spring (11), extracting the spring and fluid needle set (2-2), from the back of fluid adj. guide set (10) still assembled on the gun body (4).

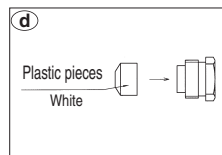
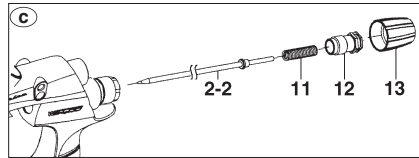

d. Fluid needle packing set (3), must always be adjusted while fluid needle set (2-2) is inserted and in the following way: tighten it by hand (about a 60 degree turn) and then with spanner. When you remove needle packing set (3), do not leave plastic piece of needle packing set (3) in the gun body.

- If you tighten fluid needle packing set (3) too much, fluid needle set (2-2) will not move smoothly, resulting in paint leakage from tip of fluid nozzle (2-1).
- Try to adjust it carefully while pulling trigger and confirming movement of fluid needle set (2-2).
- If you tighten it too much, repeat operation.

e. Air valve assembly (8), assemble air valve (8), air valve spring (9) and fluid adj. guide set (10) together. Next, insert fluid needle set (2-2) into fluid adj. guide set (10), fit it to gun body set (4) and screw fluid adj. guide set (10).

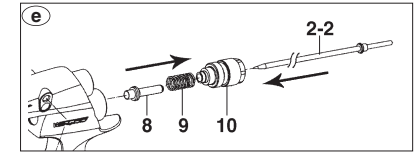

- If you try to fit air valve spring (9) and air valve (8) to gun body set (4) without fluid needle set (2-2), air valve (8) will not be fitted correctly and the packing in the fluid adj. guide set (10) will be damaged.

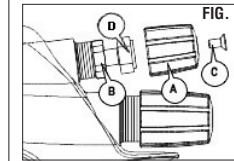

f. Disassembly of pattern adjustment set (5) and/or air adjustment set (15). In order to disassemble pattern adj. set (5) and/or air adj. set (15), first of all unscrew countersunk socket head screw Torx T10(C) and remove adjustment knob (A) by pulling out it carefully, as illustrated in Fig.1.

Then manually turn the hexagon knob (D) of the adjustment counterclockwise to open it completely and unscrew the hexagon face (B) with a spanner turning it counterclockwise.

- To reassemble pattern adjustment set (5) and/or air adjustment set (15), reverse the procedure.

IMPORTANT: Before reassembling pattern adjustment set and/or air adjustment set, make sure that these operations are carried out with the adjustment fully open (Fig.1).

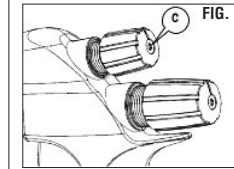

WARNING: When you reinsert the knob (6) on the adjustment (B) and before to tighten the countersunk socket screw (C), make sure that it is pushed in until it completely covers the face of the hexagon knob of the adjustment (Fig.2).

5.4 INSPECTION & REPLACEMENT STANDARD

WHERE TO INSPECT	REPLACEMENT PART
a. Each hole passage of air cap (1) and fluid nozzle (2-1).	Replace if it is crushed or deformed
b. Packing and O ring	Replace if it is deformed or worn out.
c. Leakage from seat section between fluid nozzle (2-1) and fluid needle set (2-2).	Replace them if leakage does not stop after fully cleaning fluid nozzle (2-1) and fluid needle set (2-2). If you replace fluid nozzle (2-1) or fluid needle set (2-2) only, fully match them and confirm that there is no leakage.

*ATTENTION: To disassemble Air valve seat_ part.7, use 10 mm allen wrench (Non ball point type).

To disassemble Fluid nipple_ part. 4-1, use 8 mm allen wrench.